

*X-Series shown with RA Base (XRA),
#1 Classic Molding, and optional corbels*

X Series

Standard Widths	30, 36, 42, 48, 54, 60 (Reduced widths available)
Standard Heights	24, 30, 36, 42, 48 (Reduced heights available)
Removable Options	Not available
Ventilation	Hood will be same width as available vent width. Example: To use a 36" vent model, the hood should be a minimum of 36" wide.
Available Moldings	#1 Classic, #2 Simple
Available option	Corbels - All Stanisci corbel options will fit this design (See corbel options page)
Grain Direction	Vertical

Standard Heights: 24, 30, 36, 42, 48

X- RA Base

- XRA 30*
- XRA 36
- XRA 42
- XRA 48
- XRA 54
- XRA 60

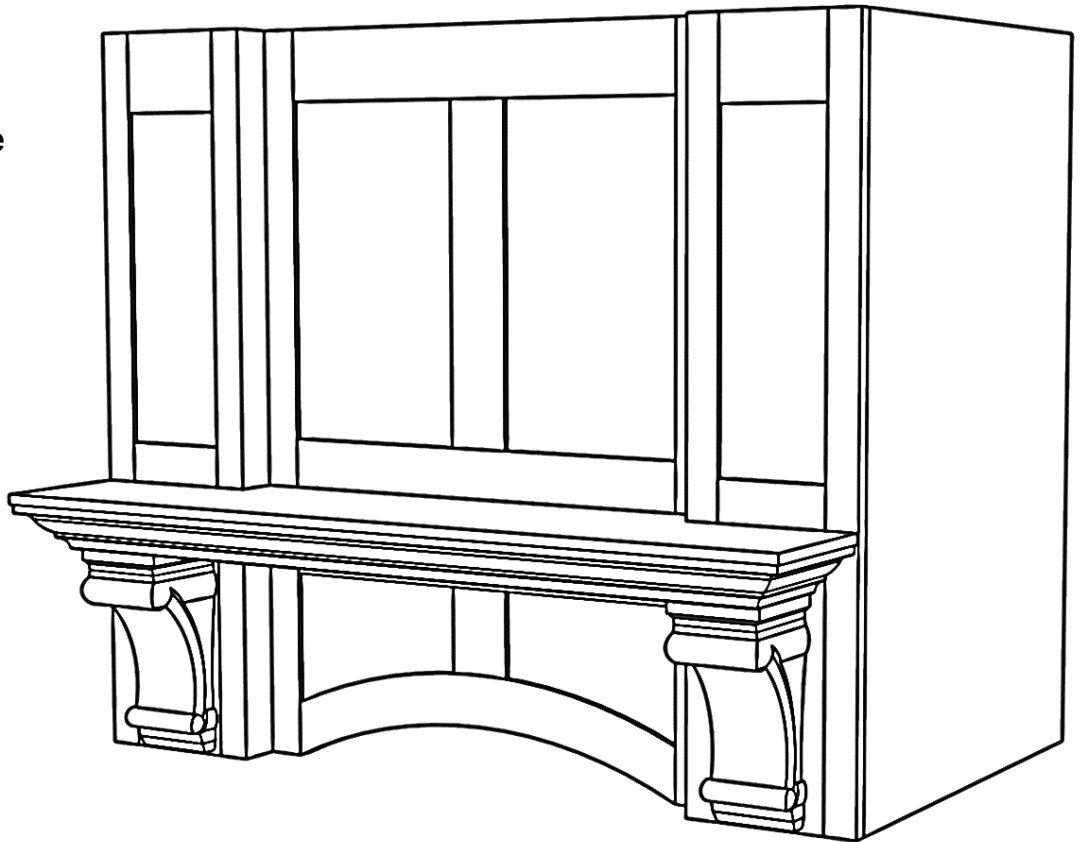

*Door Panels must be flat