

*N Series shown with DP2 Base (NDP2),  
#1 Classic molding and optional corbels  
(48" – 60" wide will have 2 center panels)*

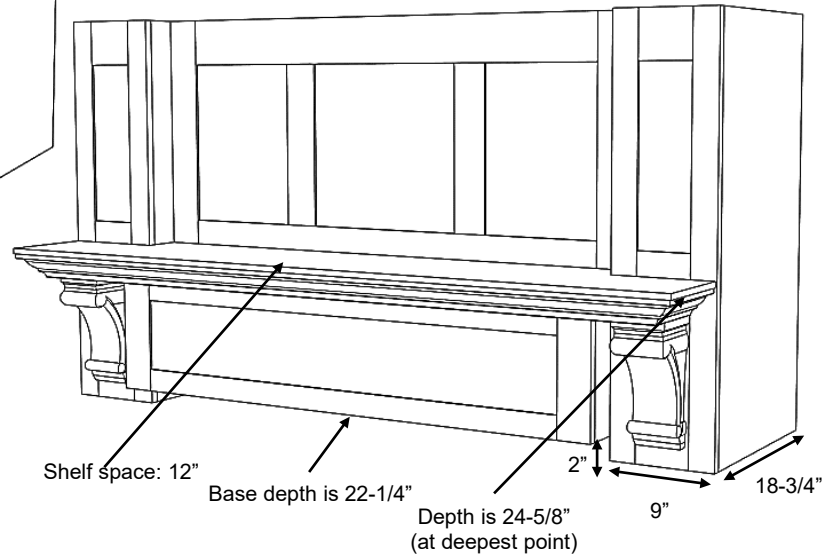

*N Series shown with RSS Base (NRSS),  
#1 Classic molding and optional corbels  
(66" – 78" wide will have 3 center panels)*

## N Series

|                    |   |
|--------------------|---|
| Standard Widths    | 48, 54, 60, 66, 72, 78 (Reduced widths available)<br>To calculate minimum width, take range width plus 18".<br>Example: A 36" range would get a 54" wide hood. (36 + 18 = 54) |
| Standard Heights   | 26, 32, 38, 44, 50 (Reduced heights available)<br>To calculate height, take ceiling height minus 64".<br>Example: A 96" ceiling would have a 32" tall hood. (96 - 64 = 32)    |
| Removable Options  | Removable Panel is standard (MRP)<br>2" fixed top rail available by request (MRP-2TR) – see modifications section.  |
| Ventilation        | Hood must be a minimum of 18" wider than available vent width.<br>Example: To use a 36" vent model, the hood should be a minimum of 54" wide                                  |
| Available Moldings | #1 Classic, #2 Simple   |
| Available Options  | Corbels - All Stanisci corbel options will fit this design (See corbel options page)  |
| Grain Direction    | Vertical (Base is horizontal)   |

Standard Heights: 26, 32, 38, 44, 50

#### N- RS Base

NRS 48  
NRS 54  
NRS 60  
NRS 66\*  
NRS 72\*  
NRS 78\*

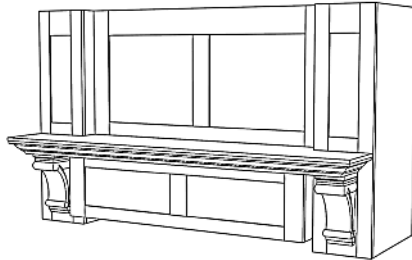

#### N- RSS Base

NRSS 48  
NRSS 54  
NRSS 60  
NRSS 66\*  
NRSS 72\*  
NRSS 78\*

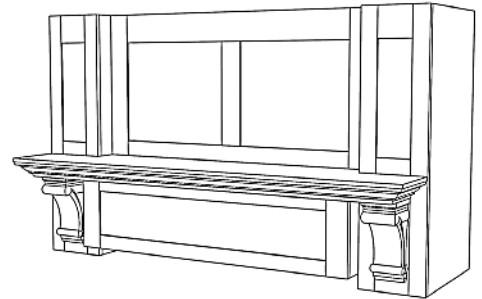

#### N- RA Base

NRA 48  
NRA 54  
NRA 60  
NRA 66\*  
NRA 72\*  
NRA 78\*

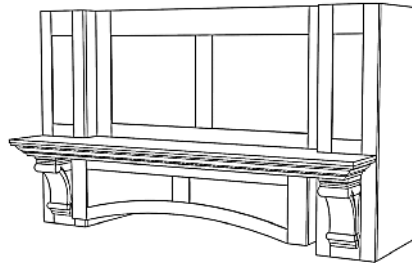

#### N- DP2 Base

NDP2 48  
NDP2 54  
NDP2 60  
NDP2 66\*  
NDP2 72\*  
NDP2 78\*

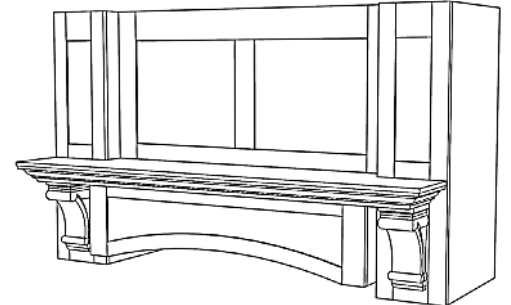

#### N- SL Base

NSL 48  
NSL 54  
NSL 60  
NSL 66\*  
NSL 72\*  
NSL 78\*

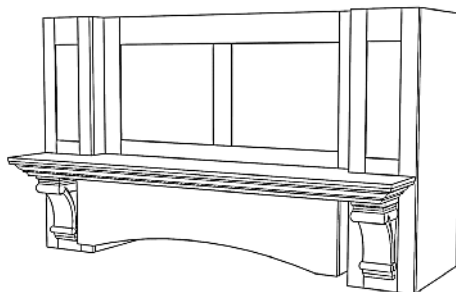

#### N- DP1 Base

NDP1 48  
NDP1 54  
NDP1 60  
NDP1 66\*  
NDP1 72\*  
NDP1 78\*

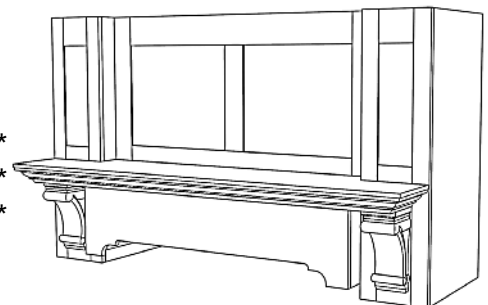

\*Top center panel is three panels rather than two, due to width of hood.