



3-1/4" tall flat for crown to wrap

Panel removes for easier installation, beads hide the seam

6-1/8" between moldings

Corbels are optional

L-Series with acanthus base and top carving, acanthus corbels and classic molding package 1
Top crown not included

19-1/2"

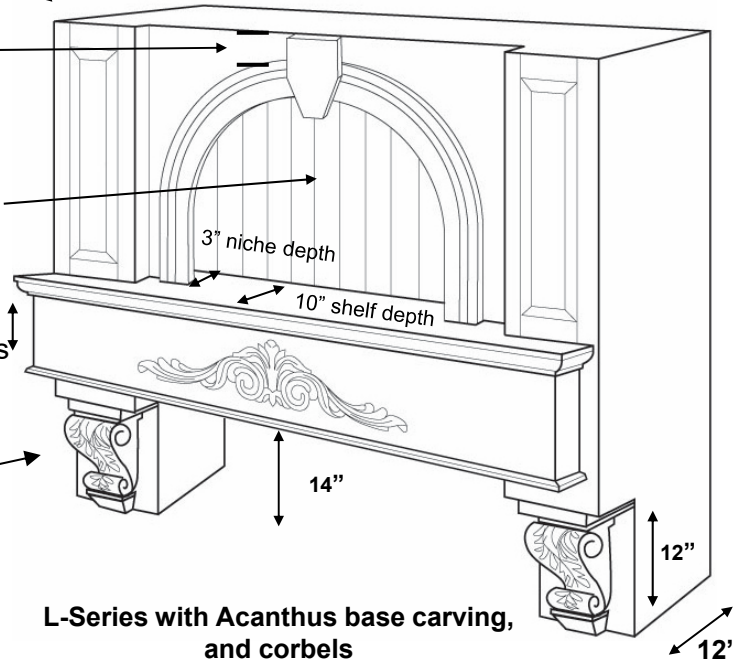

L-Series with Acanthus base carving, and corbels

L Series	
Standard Widths	54, 60, 66 or custom
Standard Heights	44, 50, 56 - To determine height take ceiling height minus 66" and plus 14". This will leave hood 30" above range .
Removable panel	Standard, - There will be bead board behind arch with seams in two beads to allow for access panel
Standard Assumptions	-9" wide columns -Recess in display niche is sized for 3" puck lights
Depth of hood	22.25"
Depth of hood to tips of moldings	Classical or Simple (24-1/2)
Distance moldings protrude past sides	0
Ventilator	Stanisci Stainless Mesh, Baffle or Value liner
Baffle liner Adjustment	N/A
Available Moldings	Classic, or Simple
Available option	-Corbels – should be around 5 x 5 x 10
Available customization	Yes – recommended if using aftermarket vent

Standard heights of 44, 50 and 56" (custom heights available)

L- Standard

L 5444
L 6044
L 6644

L 5450
L 6050
L 6650

L 5456
L 6056
L 6656

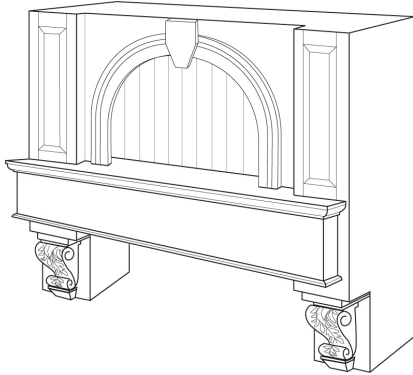

L-Applied Acanthus Base Carving

LAB 5444
LAB 6044
LAB 6644

LAB 5450
LAB 6050
LAB 6650

LAB 5456
LAB 6056
LAB 6656

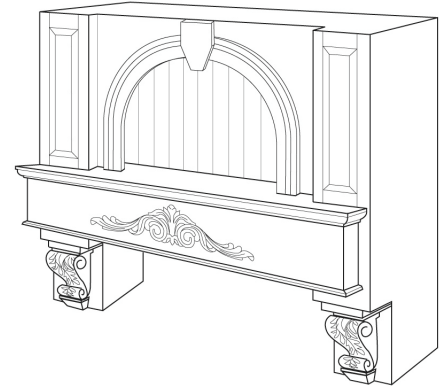

L-Applied Acanthus Base and Top Carving

LABT 5444
LABT 6044
LABT 6644

LABT 5450
LABT 6050
LABT 6650

LABT 5456
LABT 6056
LABT 6656

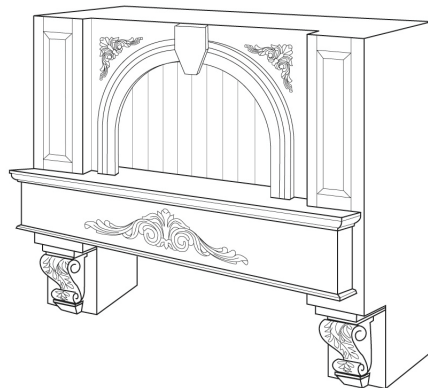

Corbels are priced separately

L-Series hood are designed to accept the following corbel sizes
COR-AC2, COR-TT2, CBL-PRW3, CBL-ART3, CBL-PPC3, CBL-ARF3