



FX Series	
Standard Widths	30, 36, 42, 48, 54 and 60 or custom
Standard Heights	24, 30, 36, 42 or custom – Order height needed – do not cut down in field
Removable Top option	<ul style="list-style-type: none"> - When ordered with upper door – door will be removable – upper door is applied and has 1/8” reveal on both sides and the top - hen ordered without upper door – not removable
Standard Assumptions	<ul style="list-style-type: none"> - Grain is horizontal <p>Customers can define number of door panels on base and top – they do not have to be the same</p> <p>Door RULES</p> <ul style="list-style-type: none"> 30” wide hoods – Can have 1-2 panels not 3 if raised 6” base – panels must be flat not raised or can increase base height to 8.75” Single panel – Requires MDF Panels – are all equal distance apart Upper panel – 1/8” reveal on top and two sides - If door on top – customer will define number of panels, hoods which are over 48” AND not MDF or flat veneered MDF will have 3 equal door panels. Single doors only available when MDF - If door on base– customer will define number of panels, hoods which are over 48” AND not MDF will have 3 equal door panels. Standard base is 6” - Base door must be FLAT panel or increased to 8.75” for raised. Grain on base will be horizontal -top depth is 12”
Depth of hood	22.25”
Ventilator	Stanisci Stainless Mesh or Value liner
Baffle liner Adjustment	- Increase to 8.75” if getting baffle
Available option	<ul style="list-style-type: none"> -Horizontal Grain – n/c -Battens Sorrento pull out spice racks
Available customization	Yes – recommended if using aftermarket vent

700 South Gaspie Street • Oxford, MI 48371 • (248) 572-6880 • email: sales@wood-hood.com • www.wood-hood.com



FX- Standard Hood

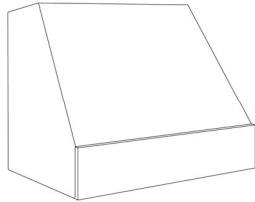

FX with batten option

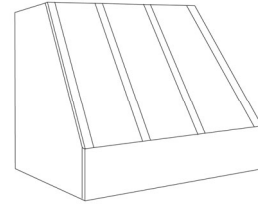

FXBP – 1 Base Panel

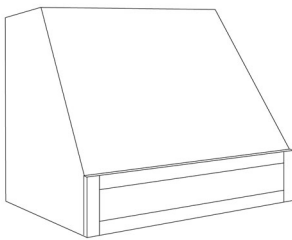

FXBP – 2 Base Panel

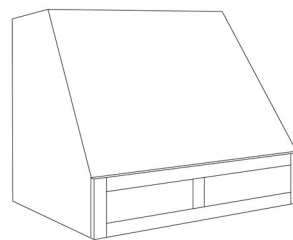

FXBP – 3 Base Panel

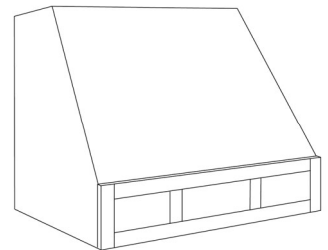

FXUP – 1- Upper Panel

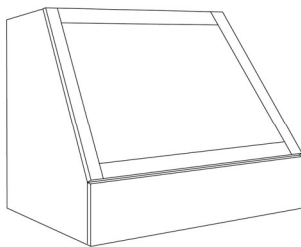

FXUP – 2- Upper Panel

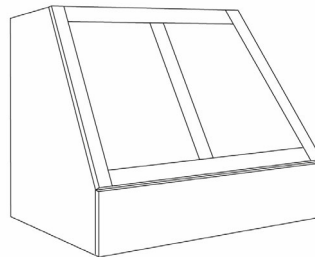

FXUP – 3- Upper Panel

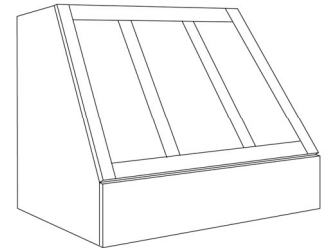

FXBPUP 2-1

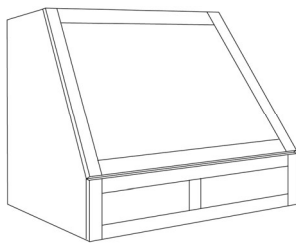

FXBPUP 1-2

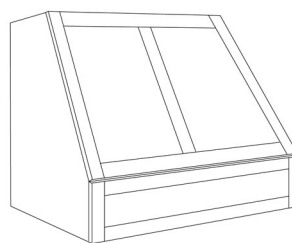

FXBPUP 1-3

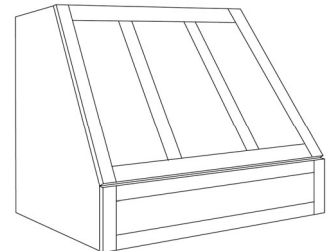

FXBPUP 3-2

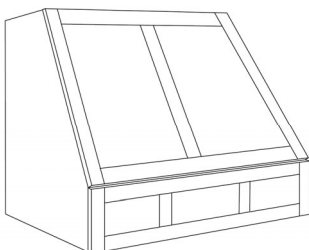

FXBPUP 2-2

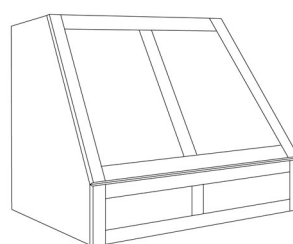

FXBPUP 3-3

