

FOR OVERALL HEIGHTS: 48" – 60"

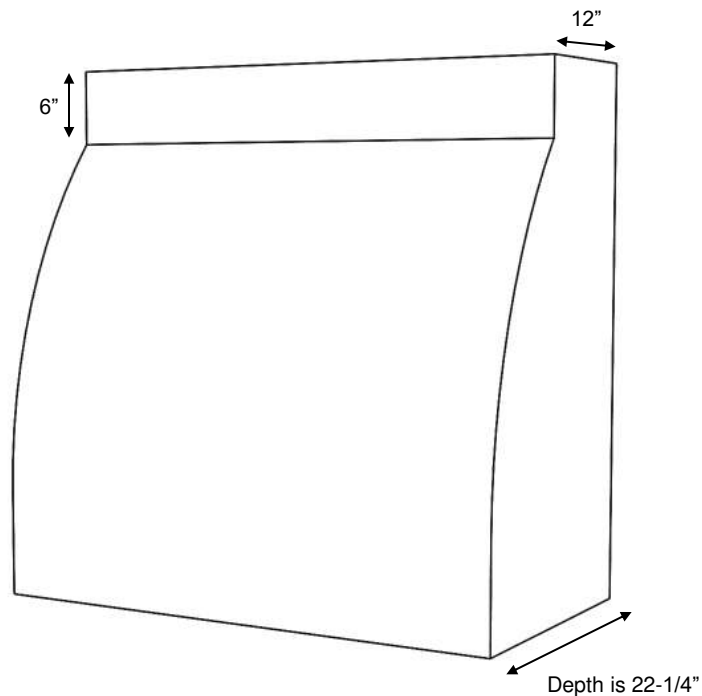

ER400 Series Hood, 42 x 48 (ER400)

ER400 Series

Standard Widths	30, 36, 42, 48, 54, 60 (Reduced widths available) *Minimum Width 30"
Standard Heights	48, 54, 60 (Reduced heights available)
Removable Options	Not available
Available Options	Hardwood Battens (See batten options page)
Ventilation	Hood will be same width as available vent width. Example: To use a 36" vent model, the hood should be a minimum of 36" wide.
Grain Direction	Vertical

700 South Glaspie Street • Oxford, MI 48371 • (248) 572-6880 • email: sales@wood-hood.com • www.wood-hood.com

Standard Heights: 48, 54, 60

ER400
ER400 30
ER400 36
ER400 42
ER400 48
ER400 54*
ER400 60*

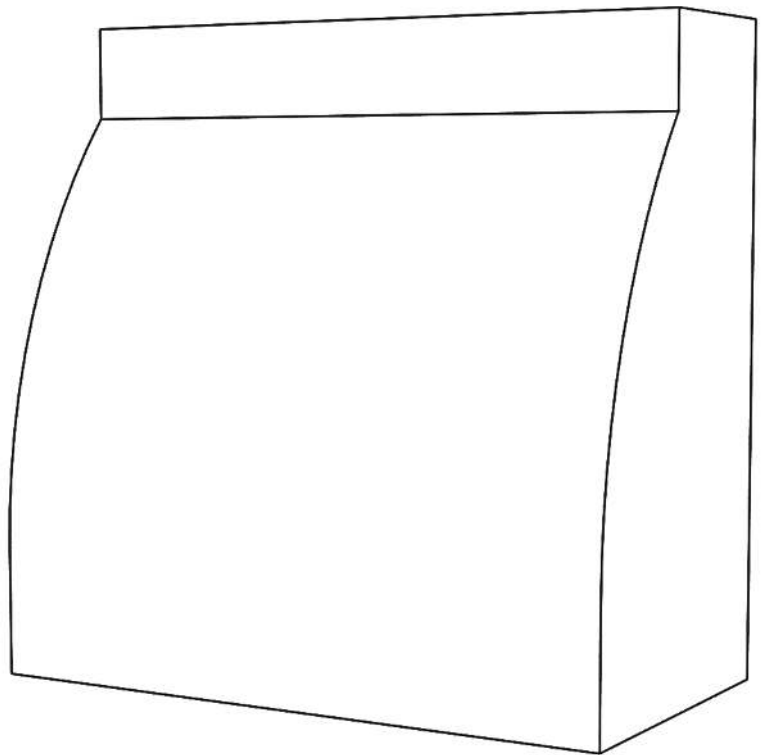

** Hoods over 48" Wide have a maximum height of 48"*

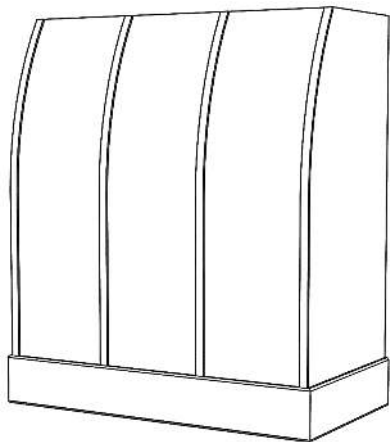

*ER200 Series shown with Hardwood Base (ER200HW)
and optional battens*

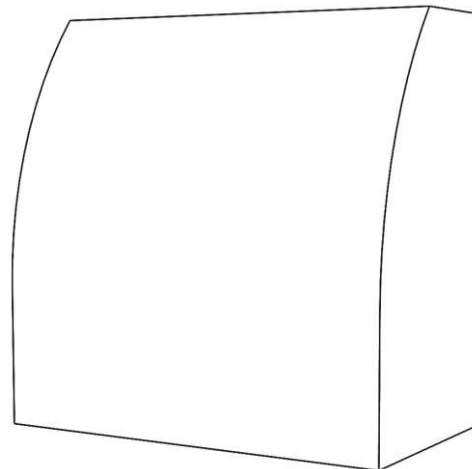

ER300 Series hood (ER300)

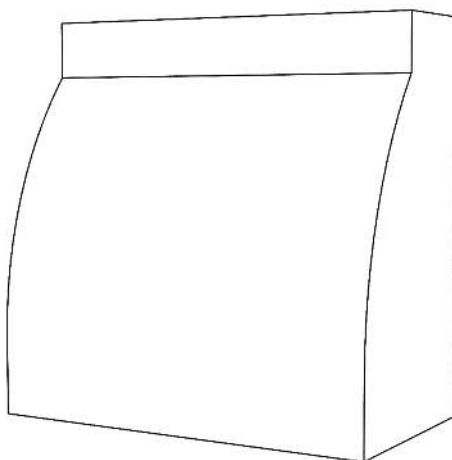

ER400 Series hood (ER400)

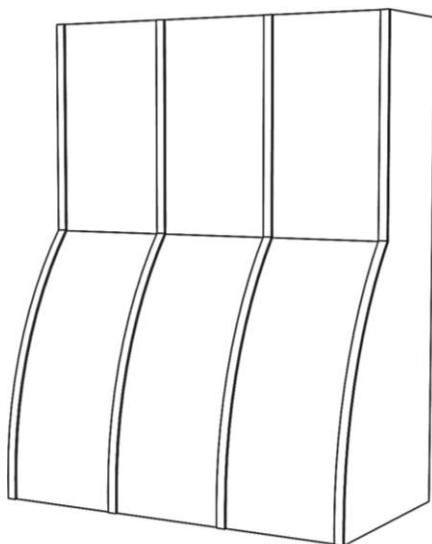

*ER500 Series hood (ER500)
shown with optional battens*

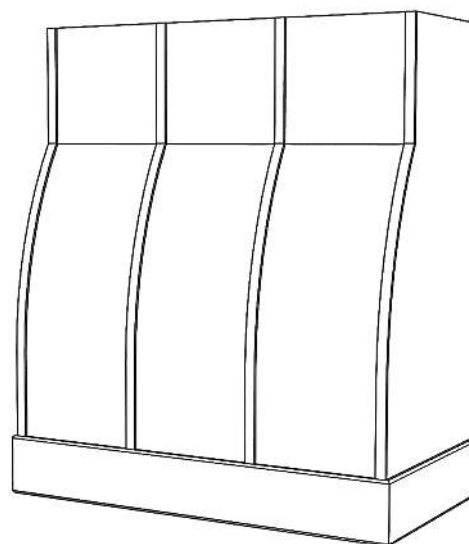

*ER600 Series hood shown with hardwood base (ER600HW)
and optional battens on curved face*

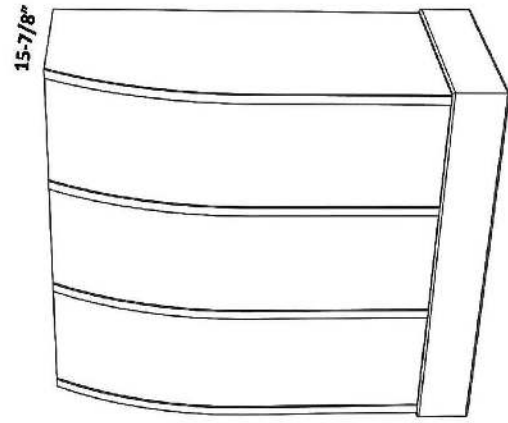

ER200 shown with hardwood base (ER200HW)
and optional battens

ER200
Free-Standing

ER500
In-Series

FOR OVERALL HEIGHT: 42" - 60"

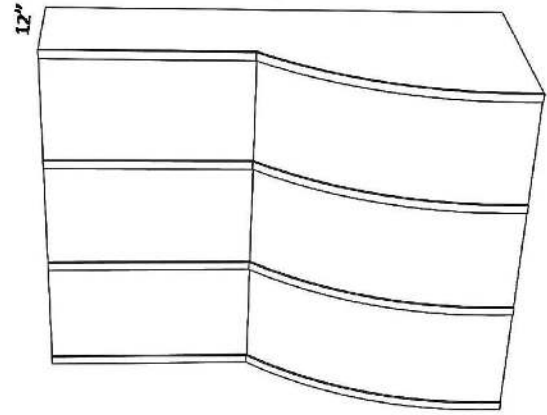

ER500 Series hood (ER500)
Shown with optional battens

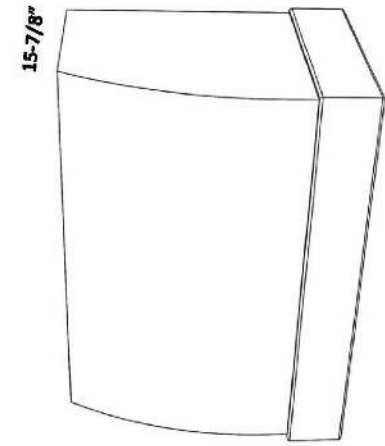

ER200 shown with hardwood base (ER200HW)

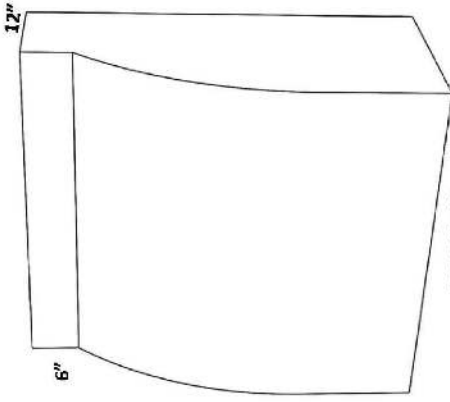

ER400 42 x 48

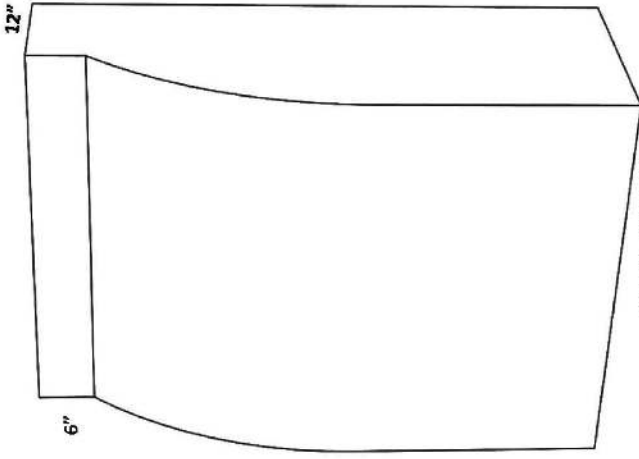

ER400 42 x 60

ER300
In-Series

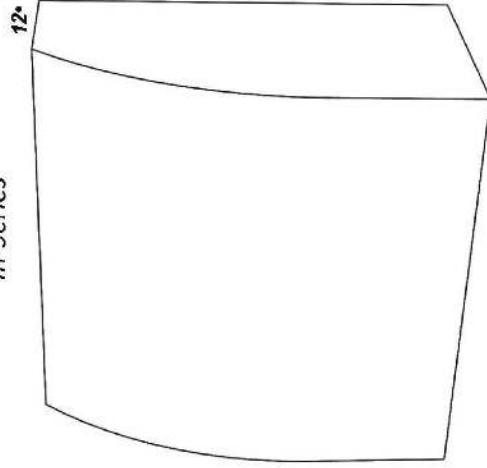

ER300 Series hood (ER300)

FOR OVERALL HEIGHT: 36"

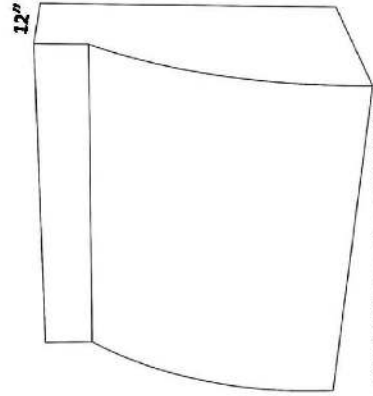

ER500 Series hood (ER500)

FOR OVERALL HEIGHT: 36"

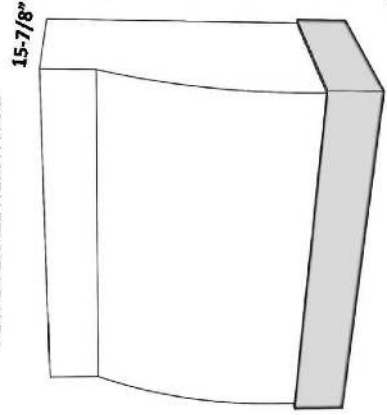

ER600 shown with SS Base (ER600SS)

ER600
Free-Standing

FOR OVERALL HEIGHT: 42" - 60"

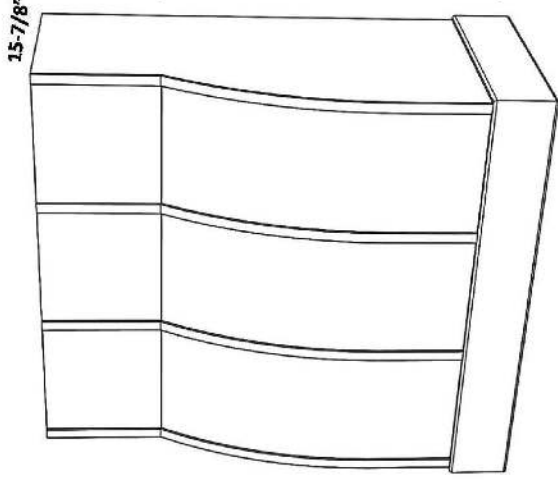

ER600 shown with hardwood base (ER600HW)
and optional battens