

ER300 Series Hood (ER300)

ER300 Series

Standard Widths	30, 36, 42, 48, 54, 60 (Reduced widths available) *Minimum Width 30"
Standard Heights	36, 42, 48, 54, 60 (Reduced heights available)
Removable Options	Not available
Available Options	Hardwood Battens (See batten options page)
Ventilation	Hood will be same width as available vent width. Example: To use a 36" vent model, the hood should be a minimum of 36" wide.
Grain Direction	Vertical

700 South Glaspie Street • Oxford, MI 48371 • (248) 572-6880 • email: sales@wood-hood.com • www.wood-hood.com

Standard Heights: 36, 42, 48, 54, 60

ER300

ER300 30

ER300 36

ER300 42

ER300 48

ER300 54*

ER300 60*

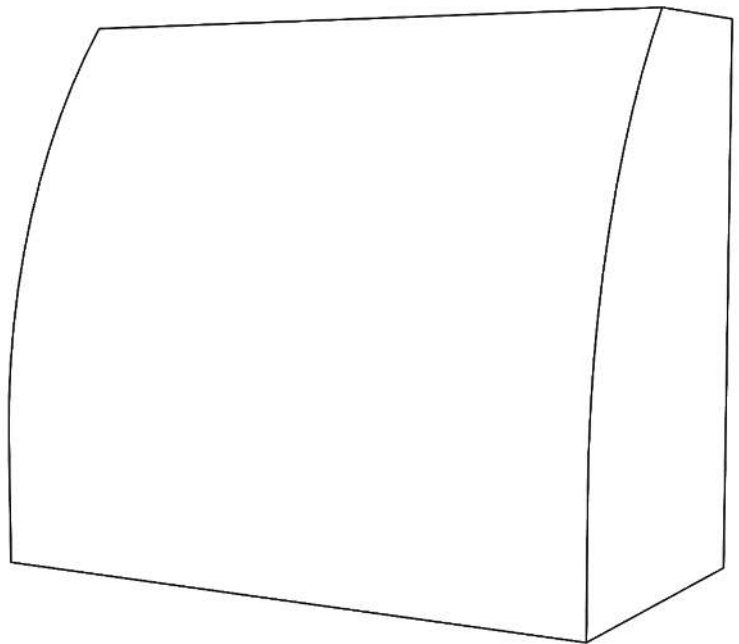

** Hoods over 48" Wide have a maximum height of 42"*

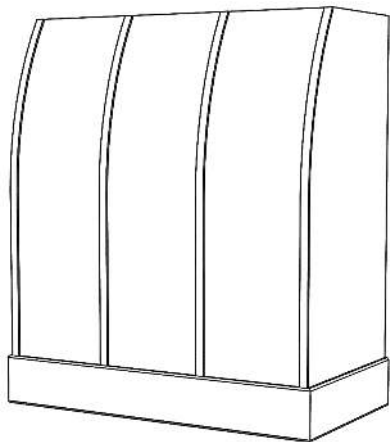

*ER200 Series shown with Hardwood Base (ER200HW)
and optional battens*

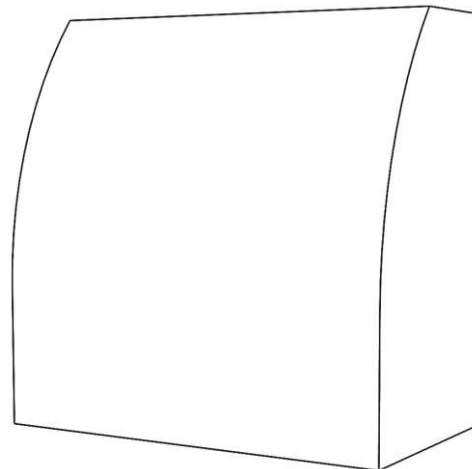

ER300 Series hood (ER300)

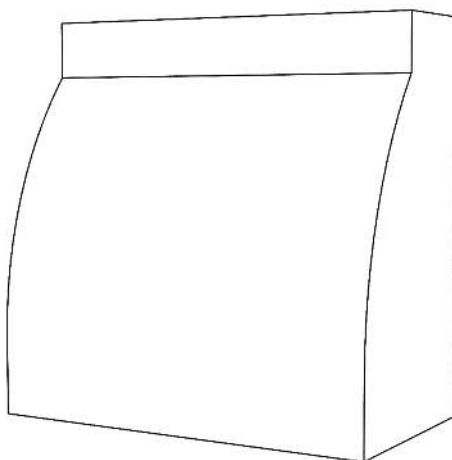

ER400 Series hood (ER400)

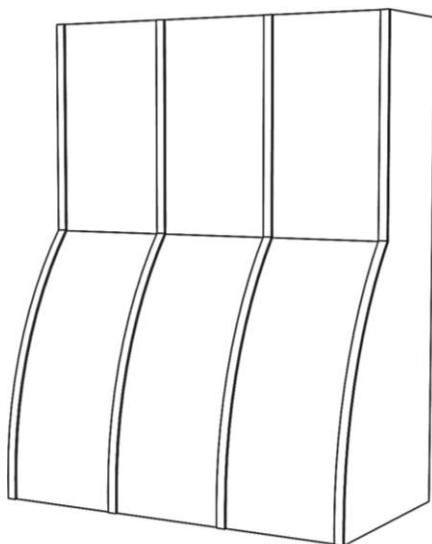

*ER500 Series hood (ER500)
shown with optional battens*

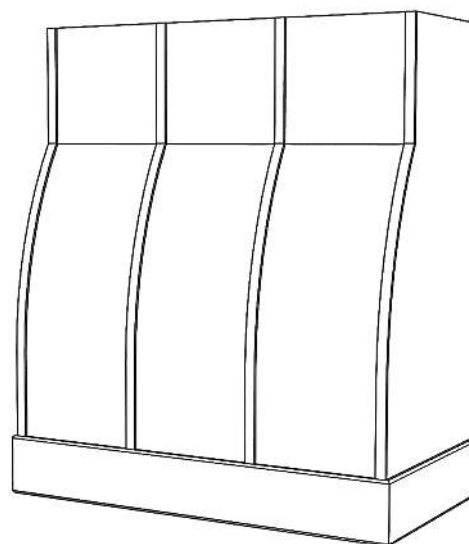

*ER600 Series hood shown with hardwood base (ER600HW)
and optional battens on curved face*

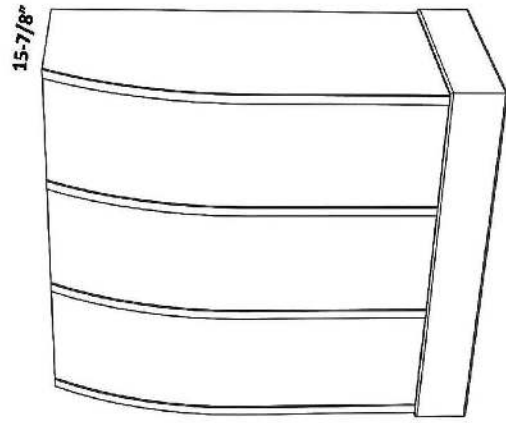

ER200 shown with hardwood base (ER200HW)
and optional battens

ER200
Free-Standing

ER500
In-Series

FOR OVERALL HEIGHT: 42 - 60"

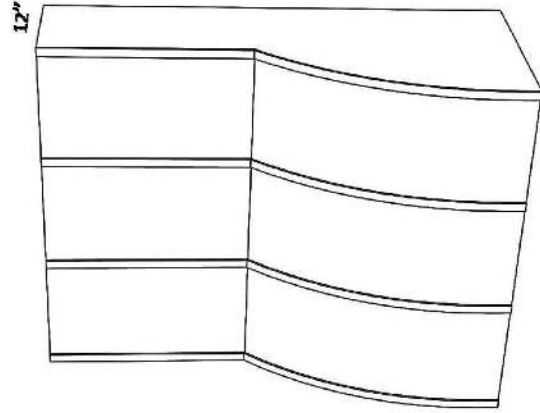

ER500 Series hood (ER500)
Shown with optional battens

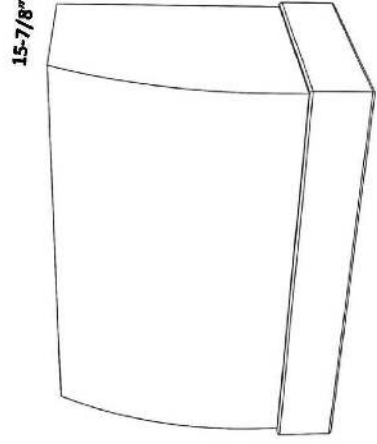

ER200 shown with hardwood base (ER200HW)

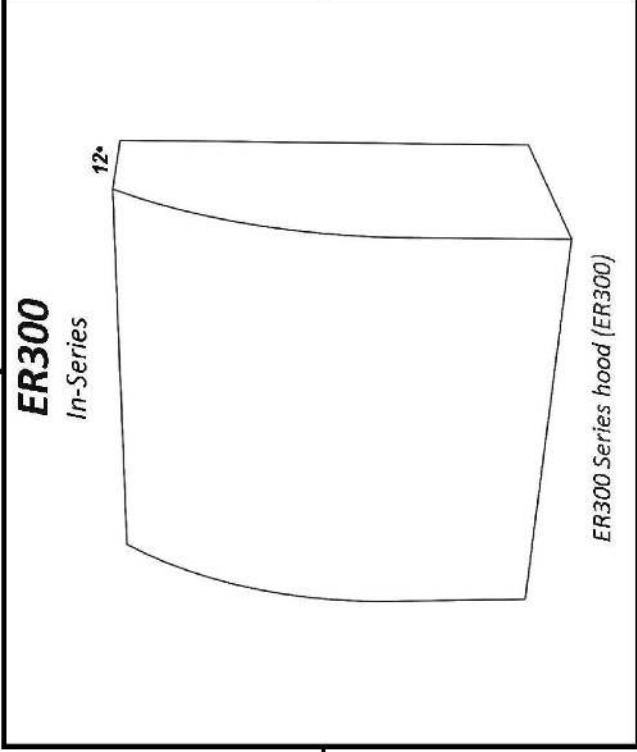

ER300
In-Series

ER300 Series hood (ER300)

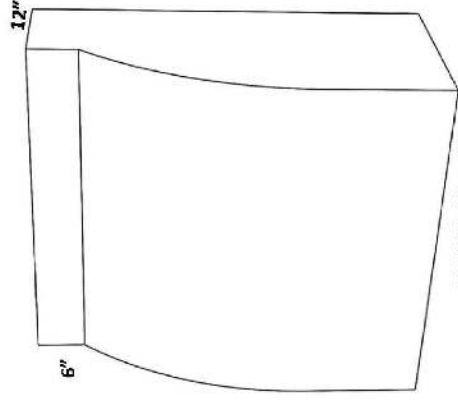

ER400 42 x 48

ER400
In-Series

ER400 42 x 60

ER600
Free-Standing

FOR OVERALL HEIGHT: 42 - 60"

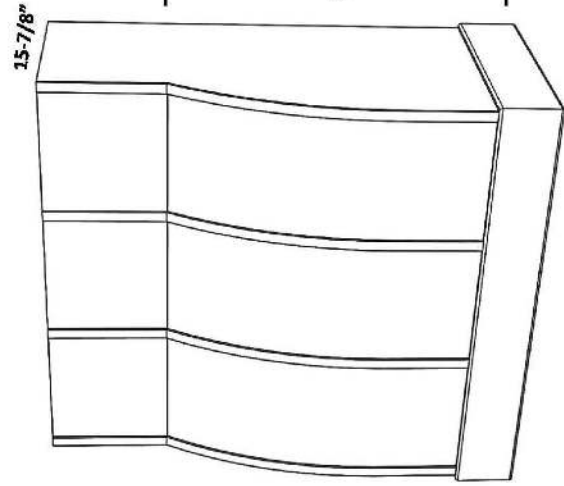

ER600 shown with hardwood base (ER600HW)
and optional battens

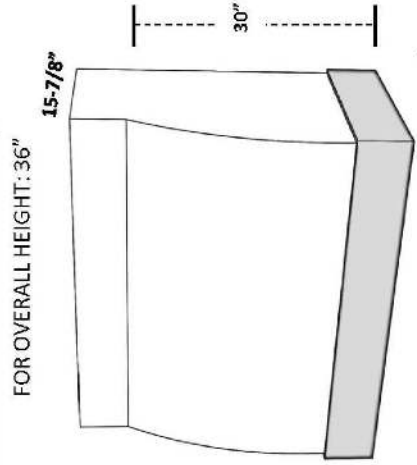

ER600 shown with SS Base (ER600SS)